

TELL-300

Cod. **T300P45S** (4,5/177) Strong
 Cod. **T300P55S** (5,5/22) Strong

Cod. **T300P45F** (4,5/177) F
 Cod. **T300P55F** (5,5/22) F

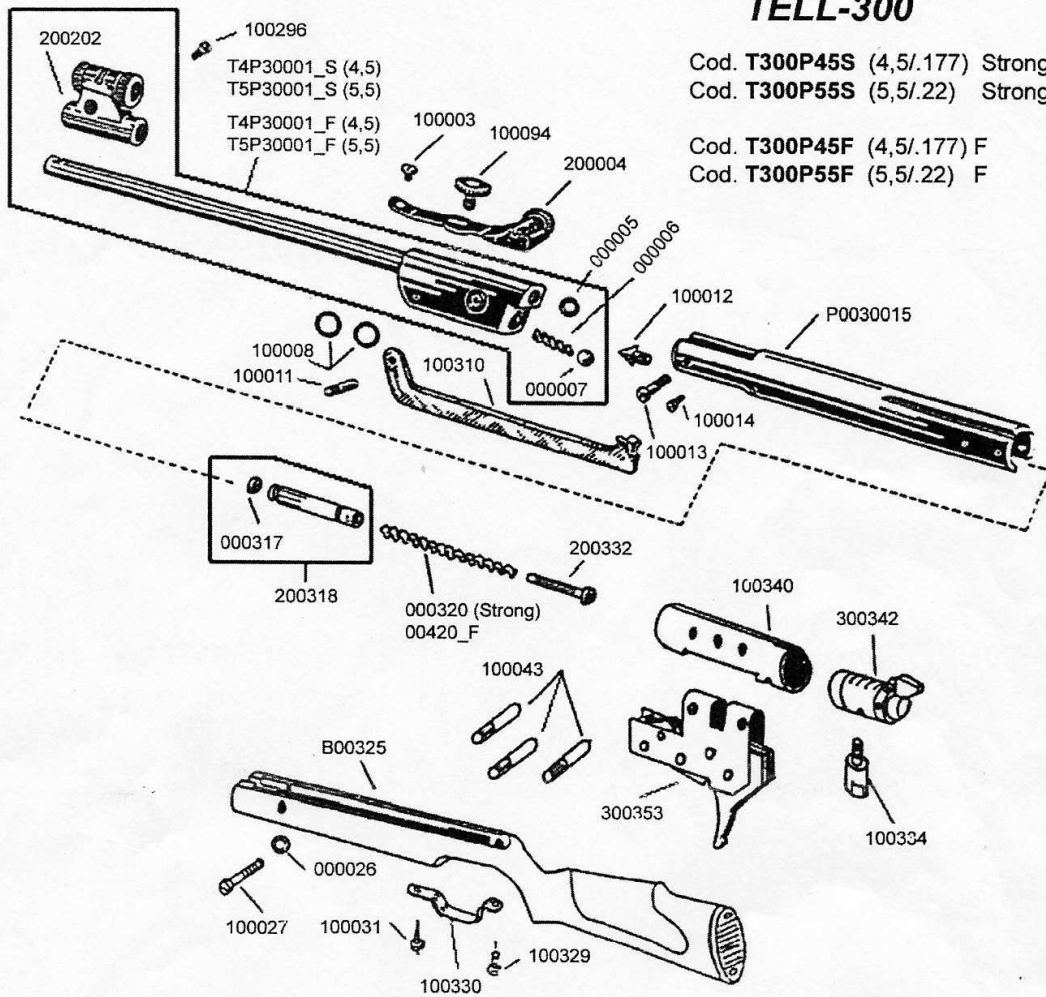

| | | | | | |
|---------------|----------------------------|---------------|---------------------------|-------------------|----------------------|
| 200202 | Front sight | 100014 | Set screw | B00325 | Butt stock |
| 100296 | Front sight screw | 300342 | Safety | 000320 | Main Spring (Strong) |
| 200004 | Rear sight | 000317 | Piston seal | 000420_F | Main Spring (F) |
| 100003 | Rear sight fixation screw | 200318 | Piston | 200332 | Main spring guide |
| 100094 | Rear sight screw, vertical | 300353 | Trigger assembly | P0030015 | Tube |
| 000005 | O ring | 100340 | Main spring support | T4P30001_S | Barrel (4,5) Strong |
| 000006 | Compressor spring | 100043 | Support pin 5x30,5 | T5P30001_S | Barrel (5,5) Strong |
| 000007 | Compressor ball | 100334 | Main spring support screw | T4P30001_F | Barrel (4,5) F |
| 100008 | Lateral washer | 000026 | Toothed washer | T5P30001_F | Barrel (5,5) F |
| 100310 | Lever | 100027 | Lateral screw | | |
| 100011 | Lever pin | 100329 | Trigger guard front screw | | |
| 100012 | Cocking cam | 100330 | Trigger guard | | |
| 100013 | Hinge pin screw | 100031 | Trigger guard rear screw | | |